

PART NO.

**RFD-1601-HPL**

| REV | DESCRIPTION         | DWN | DATE     | APPROVED |
|-----|---------------------|-----|----------|----------|
| -   | ENGINEERING RELEASE | CZS | 02/20/14 | JDMc     |

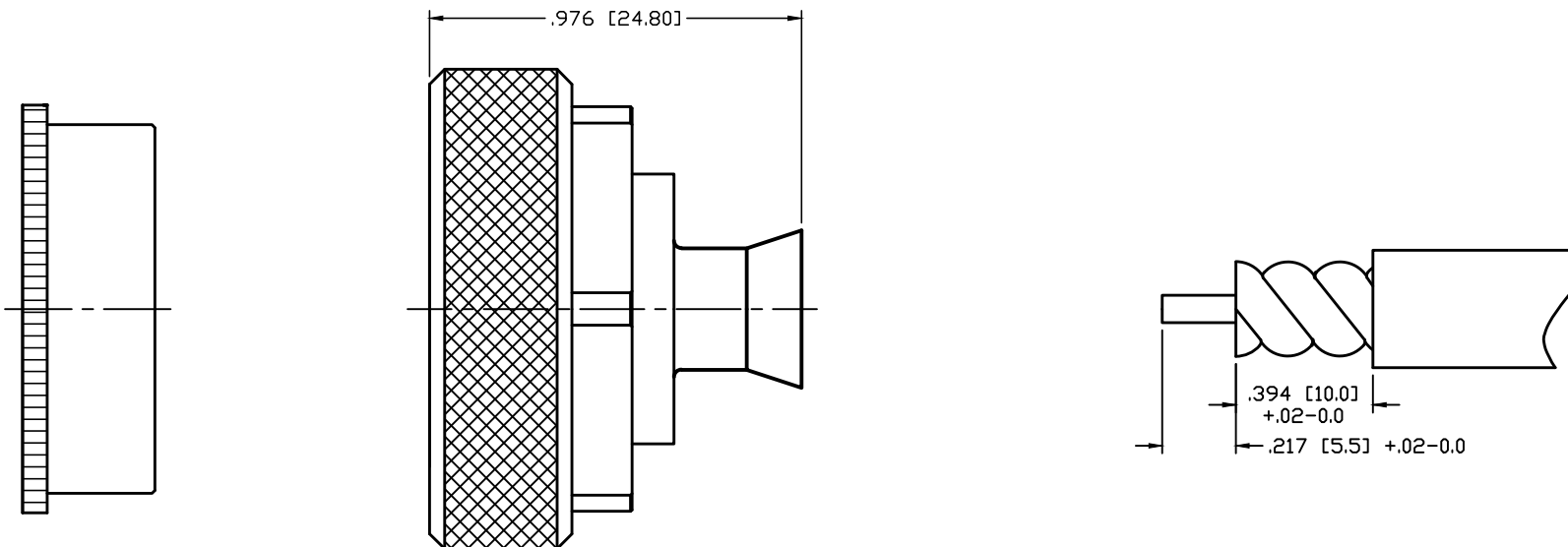

CUSTOMER  
OUTLINE DRAWING  
ALL DIMENSIONS  
ARE REFERENCE ONLY

UNLESS OTHERWISE SPECIFIED:  
DIMENSIONS ARE IN INCHES  
AND [MILLIMETERS]

**RoHS**  
**COMPLIANT**

PROPRIETARY AND CONFIDENTIAL  
THIS DRAWING CONTAINS  
INFORMATION PROPRIETARY TO  
RF INDUSTRIES, ANY  
UNAUTHORIZED USE OF THIS  
DRAWING IS EXPRESSLY  
PROHIBITED WITHOUT WRITTEN  
PERMISSION FROM RF  
INDUSTRIES. ANY VIOLATION IS  
PUNISHABLE UNDER U.S.  
COPYRIGHT LAWS.

**RFconnectors**  
DIVISION OF RF INDUSTRIES, LTD. (858) 549-6345 FAX

7610 MIRAMAR RD.  
SAN DIEGO, CA 92126  
(858) 549-6340

**7/16 DIN PLUG**  
FOR SSP250

|   |             |     |          |              |
|---|-------------|-----|----------|--------------|
| 5 | SHELL       | 1   | BRASS    | WHITE BRONZE |
| 4 | GASKET      | 1   | RUBBER   | ----         |
| 3 | PIN         | 1   | BRASS    | WHITE BRONZE |
| 2 | INSULATOR   | 1   | PTFE     | ----         |
| 1 | BODY        | 1   | BRASS    | WHITE BRONZE |
| # | DESCRIPTION | QTY | MATERIAL | FINISH       |

|           |           |          |
|-----------|-----------|----------|
| DRAWN     | C. ZUNIGA | 02/20/14 |
| CHECKED   |           |          |
| ORJ DRAWN | C. ZUNIGA | 02/20/14 |

| SIZE   | CABLE GROUP     | DWG NO.             | REV |
|--------|-----------------|---------------------|-----|
| A      | N/A             | <b>RFD-1601-HPL</b> | —   |
| SCALE: | ENGINEERING ID: | SHEET 1 OF 1        |     |
| NTS    | 001787          |                     |     |