

PART NO.		<b>PT-4000-148LP</b>	
REV	DESCRIPTION	ECO/ENR	DATE
—	ENGINEERING RELEASE	—	05/10/23
			APPROVED
			JDM

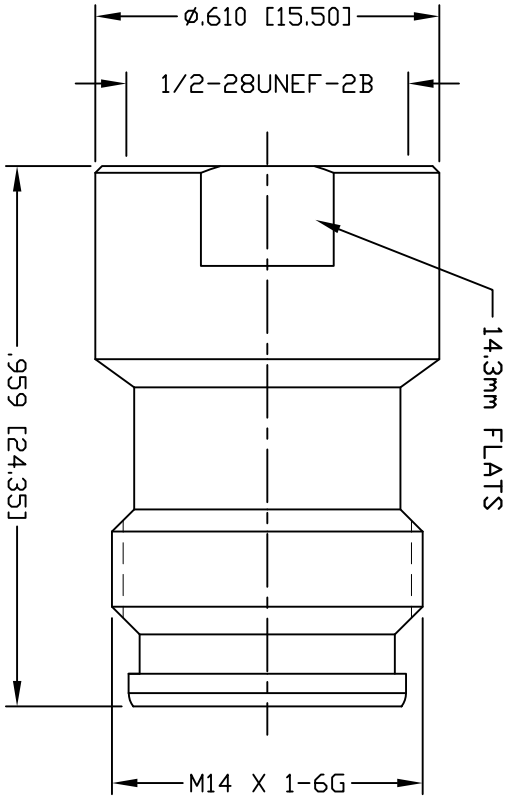

**SPECIFICATIONS:**

IMPEDANCE: 50 Ohms  
 FREQUENCY RANGE: 0-6 GHz  
 3rd ORDER IM TEST METHOD: 2x43 dBm CARRIERS  
 RETURN LOSS: 25 dB @ 0-3 GHz  
 RETURN LOSS: 19 dB @ 3-6 GHz  
 INSERTION LOSS (dB):  $\leq 0.12 \times \sqrt{f}$  (GHz)  
 WORKING VOLTAGE: 500 V rms  
 DIELECTRIC WITHSTANDING VOLTAGE: 2000 V rms MIN  
 INSULATION RESISTANCE: 5k MO. MIN.  
 TEMPERATURE RANGE: -65°C TO 165°C

#	DESCRIPTION	QTY	MATERIAL	FINISH
4	GROUND RING	1	PHOSPHOR BRONZE	SILVER
3	CONTACT	1	Be Cu.	SILVER
2	INSULATOR	1	PTFE	NATURAL
1	BODY	1	BRASS	CUSnZn

CUSTOMER OUTLINE DRAWING ALL DIMENSIONS ARE REFERENCE ONLY UNLESS OTHERWISE SPECIFIED: DIMENSIONS ARE IN INCHES AND [MILLIMETERS]	
DRAWN C. ZUNIGA	05/10/23
CHECKED C. ZUNIGA	
DRW C. ZUNIGA	05/10/23

**ROHS COMPLIANT**  
 PROPRIETARY AND CONFIDENTIAL  
 THIS DRAWING CONTAINS  
 INFORMATION PROPRIETARY TO  
 RF INDUSTRIES. ANY  
 UNAUTHORIZED USE OF THIS  
 DRAWING IS EXPRESSLY  
 PROHIBITED WITHOUT WRITTEN  
 PERMISSION FROM RF  
 INDUSTRIES. ANY VIOLATION IS  
 PUNISHABLE UNDER U.S.  
 COPYRIGHT LAWS.

**RF INDUSTRIES**  
 DIVISION OF RF INDUSTRIES, LTD. SAN DIEGO, CALIFORNIA  
 (858) 549-6340  
 RF@RFINDUSTRIES.COM

**PT-4000-148LP**  
 ADAPTER  
 UNIDAPT TO 2.2-5 FEMALE

DWG #	CONTROL #	SCALE	FORMAT	SHEET	REVISION
N/A	000000	NTS	A	1 OF 1	—