

PT-4000-152LP

PART NO.

REV	DESCRIPTION	ECO/ECN	DATE	APPROVED
-	ENGINEERING RELEASE	----	10/25/23	JDM

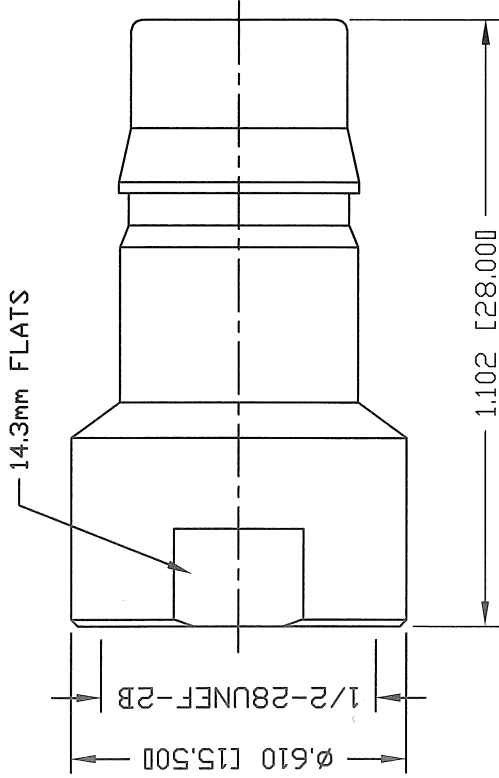

SPECIFICATIONS:

IMPEDANCE: 50 Ohms
 FREQUENCY RANGE: 0-6 GHz
 3rd ORDER IM: \leq -160 dBc (RELATIVE TO CARRIER)
 3rd ORDER IM TEST METHOD: 2x4.3 dBm CARRIERS
 VSWR: 1.25 @ 3 GHz
 VSWR: 1.35 @ 5 GHz
 INSULATION RESISTANCE: 5k M Ω MIN.
 TEMPERATURE RANGE: -40°C TO 85°C
 WORKING VOLTAGE: 500 V rms
 DURABILITY: 500 CYCLES

#	DESCRIPTION	QTY	MATERIAL	FINISH
3	CONTACT	1	BeCu	SILVER
2	INSULATOR	1	PTFE	NATURAL
1	BODY	1	BRASS	CuSnZn

CUSTOMER
 OUTLINE DRAWING
 ALL DIMENSIONS
 ARE REFERENCE ONLY

UNLESS OTHERWISE SPECIFIED:
 DIMENSIONS ARE IN INCHES
 AND [MILLIMETERS]

DRAWN
 C. ZUÑIGA

CHECKED
 C. ZUÑIGA

DATE
 10/25/23

ROHS
COMPLIANT

PROPRIETARY AND CONFIDENTIAL
 THIS DRAWING CONTAINS TO
 INFORMATION PROPRIETARY TO
 RF INDUSTRIES. ANY
 UNAUTHORIZED USE OF THIS
 DRAWING IS EXPRESSLY
 PROHIBITED WITHOUT WRITTEN
 PERMISSION FROM RF
 INDUSTRIES. ANY VIOLATION IS
 PUNISHABLE UNDER U.S.
 COPYRIGHT LAWS.

RFconnectors
 DIVISION OF RF INDUSTRIES, LTD. SAN DIEGO, CALIFORNIA
 RFINDUSTRIES.COM
 (858) 549-6340
 RF@RFINDUSTRIES.COM

UNIDAPT TO QN FEMALE
 ADAPTER

DWG #

PT-4000-152LP

CABLE GROUP
 N/A

CONTROL #
 000000

SCALE
 NTS

FORMAT
 A

SHEET
 1 OF 1

REVISION
 -