

PART NO.

**RFD-43MS-HPL**

| REV | DESCRIPTION   | ECO/ECN | DATE     | APPROVED |
|-----|---------------|---------|----------|----------|
| C   | UPDATED SPECS | 1029    | 03/14/24 | JDM      |

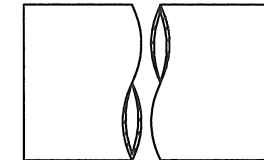
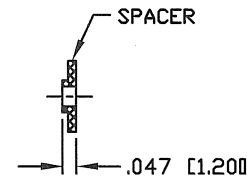
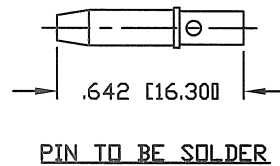
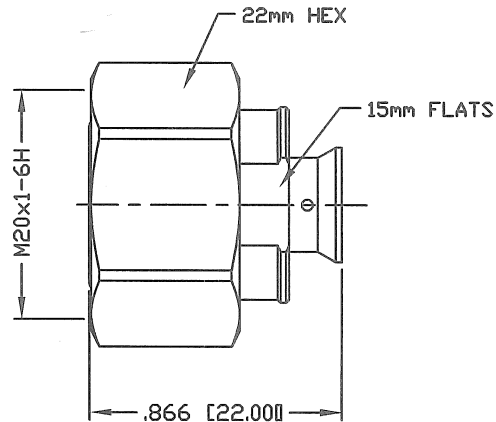

TUBING NOT TO SCALE

**SPECIFICATIONS:**

INTERFACE: IEC61169-54

IMPEDANCE: 50 Ohms

FREQUENCY RANGE: 0-6 GHz

INSERTION LOSS: 0.1 dB MAX

VSWR: &lt;1.15:1 THRU 3 GHz

3rd ORDER IM:  $\leq -160$  dBc @ 700 MHz & 1900 MHz

3rd ORDER IM TEST METHOD: 2x43 dBm CARRIERS

DC TEST VOLTAGE: 2500 V @ SEA LEVEL

INSULATION RESISTANCE: 5000 M $\Omega$ 

TEMPERATURE RANGE: -55°C TO 90°C

COUPLING TORQUE:  $\geq 3.7$  FT-LB ( $\geq 5$  Nm)

MATING CYCLES: &gt;100

NET WEIGHT: 0.08 lb

ENVIRONMENTAL: IEC 60529, IPX8 (2.5 BAR, 1 HOUR)

IEC 61169-1 CLAUSE 9.4.6 48 HOUR SALT MIST, 35°C

USED ON: SPP-250-LLPP, SPO-250, SCF14-50J, SPF-250,

FSJ1-50A, PTS1-50-P, TFT-401, EC1-50-HF

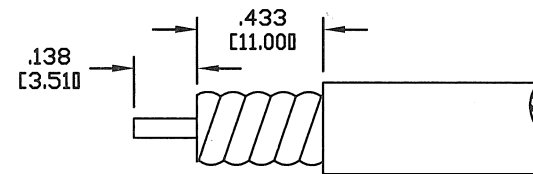
**RECOMMENDED STRIPPING DIMENSIONS**

USE COMPATIBLE TRIM TOOL SUCH AS MCPT-1412

| # | DESCRIPTION    | QTY | MATERIAL    | FINISH  |
|---|----------------|-----|-------------|---------|
| 8 | TUBING         | 1   | HEAT SHRINK | BLACK   |
| 7 | SHELL          | 1   | BRASS       | CuSnZn  |
| 6 | RETAINING RING | 1   | BeCu        | CuSnZn  |
| 5 | O-RING         | 1   | S.I. RUBBER | RED     |
| 4 | SPACER         | 1   | PTFE        | NATURAL |
| 3 | INSULATOR      | 1   | PTFE        | NATURAL |
| 2 | PIN            | 1   | BRASS       | SILVER  |
| 1 | BODY           | 1   | BRASS       | CuSnZn  |

CUSTOMER  
OUTLINE DRAWINGALL DIMENSIONS  
ARE REFERENCE ONLYUNLESS OTHERWISE SPECIFIED:  
DIMENSIONS ARE IN INCHES  
AND [MILLIMETERS]DRAWN  
C. ZUÑIGA 03/14/24

CHECKED

ORJ DRAWN  
C. ZUÑIGA 10/12/15**RoHS  
COMPLIANT**PROPRIETARY AND CONFIDENTIAL  
THIS DRAWING CONTAINS  
INFORMATION PROPRIETARY TO  
RF INDUSTRIES. ANY  
UNAUTHORIZED USE OF THIS  
DRAWING IS EXPRESSLY  
PROHIBITED WITHOUT WRITTEN  
PERMISSION FROM RF  
INDUSTRIES. ANY VIOLATION IS  
PUNISHABLE UNDER U.S.  
COPYRIGHT LAWS.**RFconnectors**  
DIVISION OF RF INDUSTRIES, LTD. SAN DIEGO, CALIFORNIARFINDUSTRIES.COM  
(858) 549-6340  
RFI@RFINDUSTRIES.COM**4.3/10 MALE**

1/4" SUPERFLEX CABLE

DWG #

**RFD-43MS-HPL**

| CABLE GROUP | CONTROL # | SCALE | FORMAT | SHEET  | REVISION |
|-------------|-----------|-------|--------|--------|----------|
| HPL         | 000000    | NTS   | A      | 1 OF 1 | C        |